

Wireless

Charger USER MANUAL

Multifunctional Wireless Charging Pad
(with desktop holder)



Wireless

Charger

NETTEC

Multifunctional Wireless Charging Pad (with desktop holder)

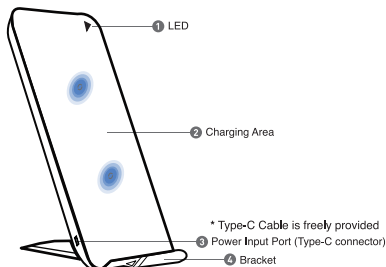

Product Specifications

- Input: 9V 1.67A/5V 2A
- Output: 9V 1A/5V 1A
- Power: 10W/5W
- Frequency: 105-205Khz
- Conversation Efficiency: 70%
- Charging Distance: 2-8mm
- Product Size: 135.5x71.5x9.5mm

Wireless

Charger

NETTEC

Multifunctional Wireless Charging Pad (with desktop holder)

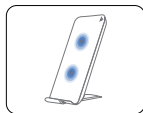

Dual Coil Design

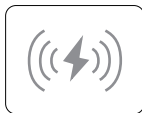

Support fast charging

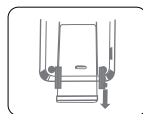

Metal bracket design

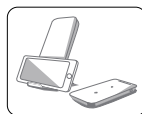

Support vertical /
parallel / horizontal mode

Kind Reminder

- You are required to use 5V/2A or 9V/1.5A adapter to match this wireless charger (Apple original adaptor (5V/1A) is not applicable).
- In the process of charging, do not put any metal materials like key, ring, metallic phone case etc., on the back of phone device or wireless charger directly.
- It may occur occasional intermittent charging or serious heating due to the unjustified position of phone receiver coil and wireless charging, please try to move the phone up and down to carry out the alignment.

Caution

1. It may appear devices uncharged or unstable charging or low current if you use your own cable, please use our Type-C cable.
2. When you use this product, please make sure the current of your adaptor is 5V 2A or it has fast charging function with high quality.
3. This product has over current protection, the product will be shut off or reduce output. If you use in wrong method, please check whether your device is abnormal or not.
4. DO NOT Expose this product to water, fire or overheated and lower temperature environment the product will be unavailable, DO NOT let children to touch accessories
5. DO NOT disassemble or remake this product, or may damage the safe protection equipment and cause battery high heat, on fire and explosion
6. DO NOT throw and attack this device strongly, it may cause product abnormal issue, please stop to use it and contact your manufacturer.
7. Please use clean cloth to clear product surface, DO NOT use chemistry material and soap to clean.
8. Manufacturer will not be responsible for those defects which caused by users. Please kindly understand.

Product Warranty

Product warranty based on packaging

Date of purchase: _____

Purchaser: _____

Contact phone number: _____

Importer :
HONG SHUO TECHNOLOGY, CO., LTD.
TEL: 0800-887-722
(Service Time: 10:00am-5:00pm)
7F, No.97, Zhongcheng Rd.,
Tucheng Dist., New Taipei City
236, Taiwan (R.O.C.)

(Dealer shop chapter)

NETTEC



Wireless

Charger

NETTEC

雙線圈無線充電盤(平躺立架2 in 1)

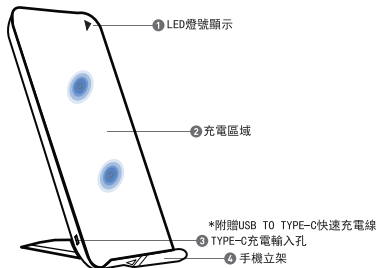

產品規格

- 使用頻率:105至205KHz
- 供應電源:Power from adapter to USB to TYPE-C cable
- INPUT:9V DC/1.7A;5V DC/2A
- OUTPUT:9V DC/1.2A;5V DC/1A
- 輸出功率:10W/5W
- 轉換效率:70%>
- 充電距離:Launch distance:2-8mm
- 天線型式:雙線圈

Wireless

Charger

NETTEC

雙線圈無線充電盤(平躺立架2 in 1)

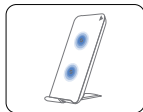

雙線圈設計

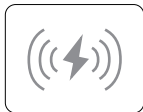

支援10W無線快充模式

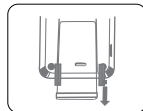

隱藏式金屬支撐立架

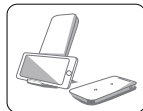

支援立/臥式充電

警告事項

1. 使用時如配用之本機標配以外的資料線或電源線使用時,可能會出現充電不穩定、電流小的現象,請使用本機標配的 TYPE-C 專用電源線。
(使用本產品時,請使用輸出電壓為DC 5V/2A或帶有快速充電功能的適配器)
2. 本產品具有過充保護功能,如使用不當產品會關閉或減小輸出功率,請檢查是否設備有異常 或其它使用不當。
3. 不要將本產品置於於水、火或過熱和較低的溫度環境下的產品將無法使用,不要讓兒童觸碰。
4. 請勿拆解或改造本產品,否則可能會損壞安全防護設備,並導致手機電池溫度升起。
5. 請勿垂掛裝置,它可能會導致產品異常問題,請停止使用並聯繫您的製造商。
6. 請用乾淨的布來清除產品表面,不使用化學物質和肥皂乾淨。

產品保固

產品保固依照外包裝標示為主

購買日期: _____

購買人: _____

聯絡電話: _____

進口商

閎碩科技股份有限公司
 客服專線: 0800-887-722
 (服務時間AM10:00-PM5:00)
 236新北市土城區忠孝路97號7樓

(為確保權益請加蓋經銷商店章)

注意事項

- 建議使用5V/2A 或 9V/1.5A 以上的USB充電器
(iPhone原廠充電器為5V 1A無法支援快充)
- 智能識別FOD金屬異物,請支持手機感應充電,避免發生過載及過熱隱患
- 當智能裝置充電時發生斷斷續續或是異常發熱的狀態下,請重新移動裝置並對準無線感應線圈,並重新啟動充電。